

FMN-M Series - Manual clamping element for miniature linear guides

Manual clamping element for miniature linear guides.

By acting on the locking screw, the contact sections press with sync on the surfaces of the rail.

The floating profiles of contact ensure a symmetrical distribution of the force on the linear guide.

New ergonomic design to save space.

FMN ##---



Guide size **9 ÷ 15 mm**
 Working type **Manual**
 Body **Steel**

- ◆ Simple and inexpensive
- ◆ Floating locking contacts

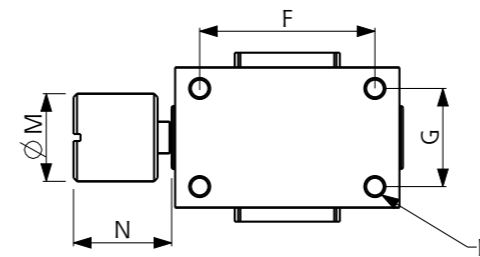
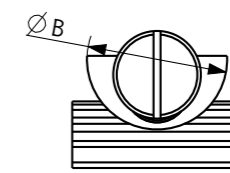
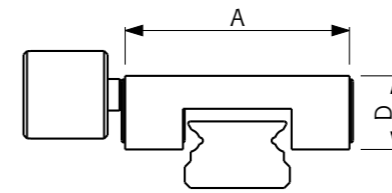

Type	Size	Clamping Force [N]	A [mm]	B [mm]	D [mm]	F [mm]	G [mm]	M [mm]	N [mm]	R
FMN	9 M	100	20	17	7.3	15	11	8	9	M3x3
FMN	12 M	150	27	19	9.5	20	13	10	10	M3x4.5
FMN	15 M	180	32	20	10.5	25	14	12.5	14	M3X5